

# CIRRUS Network Meeting

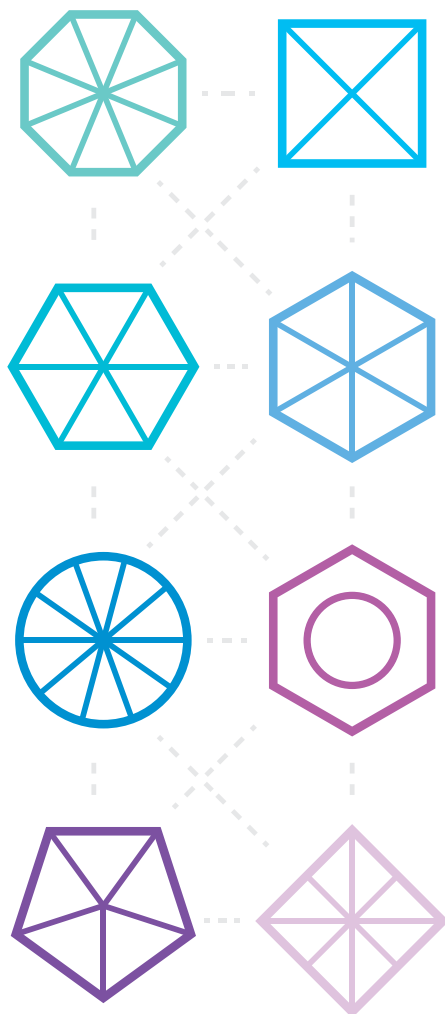

24.-26.2.2016

# Program



## Tuesday 23.2.

- 19:00 **Informal get-together**  
Meeting point at: City Hotel lobby, Pekankatu 9

## Wednesday 24.2.

- 10:00-11:30 **Visit to the Arctic Centre and Arktikum**  
Pohjoisranta 4
- 11:30 **Transfer from Arktikum to the University**  
Registration to CIRRRUS meeting at the lobby
- 12:00-13:00 **Lunch at the University of Lapland**  
Restaurant Petronella
- 13:00-13:30 **Welcoming words**  
Rector Mauri Ylä-Kotola  
Dean Timo Jokela  
Castren Hall LS11
- 13:30-15:00 **Tour in the faculty**  
Visiting labs, workshops and the degree programs
- 15:00-15:30 **Coffee break at Café Petronella**
- 15:30-17:00 **Joint session: Final thesis presentations:  
examples of 3 institutions & discussion**  
Chair: Marjatta Heikkilä-Rastas
- 17:00 **Transfers from university to hotels**
- 18:00 **Transfer from City Hotel to the Arctic Circle  
Dinner in Santamus**
- 21:30 **Transfer back to hotels**

## Thursday 25.2.

08:45	<b>Transfer from City Hotel to university</b>		
09:00-09:15	<b>Sámi Education &amp; Design</b> Liisa Holmberg Rector: Sámi Education Institute Inari	<b>Teacher's Program:</b> <b>ADW Session on User Experience</b> Korundi House of Culture	
09:15-12:00	<b>Leadership Meeting</b> Castren LS11		<b>Coordinators Meeting</b> F2059 / F2060
12:00-13:00	<b>Lunch at the University of Lapland</b> Restaurant Petronella		
13:00-14:45	<b>Design in Context</b> Lone Dalsgaard André Castren Hall LS11	<b>Transfer to University &amp; Lunch</b>	
14:45-15:15	<b>Coffee break</b>	<b>Teacher's Program:</b> <b>Rapid Prototyping Workshop</b> F-wing workshops	
15:15-16:00	<b>Strategic Design Challenges Design Education</b> Päivi Tahkokallio Kristian Keinänen Castren LS11		<b>Coordinators Workshop</b> F2059 / F2060
17:00	<b>Conclusions of the day</b> Castren Hall LS11		
17:30	<b>Transfer from university to City Hotel</b>		
18:30	<b>Departure to Arctic Snow Hotel</b> Lehtojärvi, Sinettä		
19:00	<b>Arctic Design Week: Arctic Speed Design Pitching</b> Networking and dinner (Warm clothing required!) Dress code: "Arctic Forest Casual"		
21:30 / 22:30	<b>Transfers back to city</b>		

## Friday 26.2.

- 08:45 **Transfer from City Hotel to university**
- 09:00 **Teachers program:  
Rapid prototyping workshop continues**  
F-wing workshops
- 10:30 **Transfer from City Hotel to university**
- 11:00-12:00 **Joint session on quality**  
Jaana Erkkilä  
F2060
- 12:00-13:00 **Farewell & Lunch**  
Restaurant Petronella
- 13:00 **Transfer from university to City Hotel**

## Friday Optional Programme

- 14:00-16:00 **Snowmobile Safari**  
Lapin Safarit  
Koskikatu 1
- 18:00-23:00 **Evening Dinner at Korundi Art Museum**  
Fine dine design dinner with chef Tero Mäntykangas in Korundi, Rovaniemi Art Museum in the STILL/LIFE Tapio Wirkkala exhibition (Wirkkala's 100th anniversary).

## Saturday 27.2.

- 18:00 **Arctic Design Week Fashion show**  
University of Lapland, F-wing Agora



# General Information

- Wifi Access** Eduroam Wi-Fi access is available throughout the campus area. Visitor Wi-Fi is available under “Guest” network with the security key “guest2015”.
- Contact Information** Virpi Nurmela  
virpi.nurmela@ulapland.fi  
+358 40 4844 396

## Meeting Venues

**University of Lapland**  
Yliopistonkatu 8

**The Arctic Centre & Arktikum**  
Pohjoisranta 4

**Korundi House of Culture**  
Lapinkävijäntie 4

**Santamus**  
Joulumaantie  
Arctic Circle

**Arctic Snow Hotel**  
Lehtoahontie 27  
Sinettä

**Lapin Safarit**  
Koskikatu 1

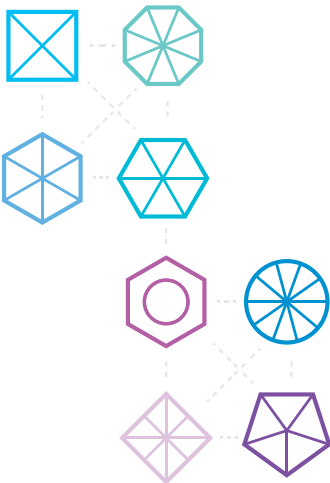

# Map of the Campus

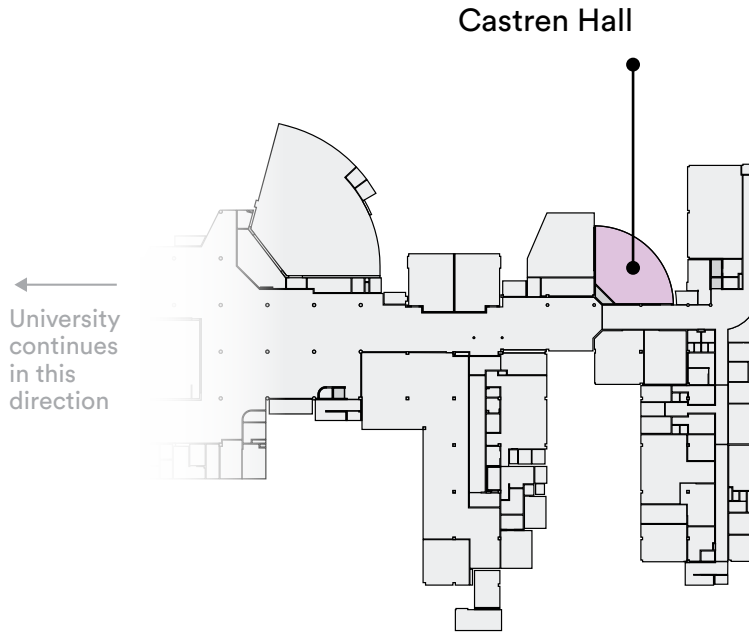

## 2nd floor

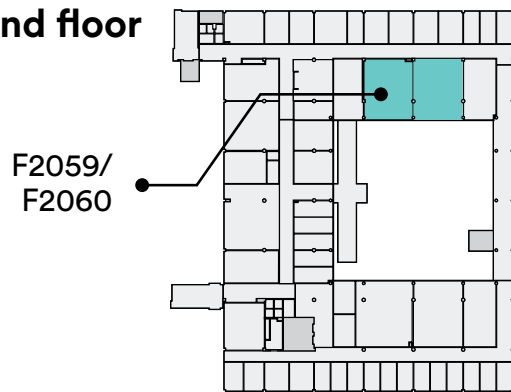

### 1st floor

Workshops

SINCO

Restaurant

Petronella

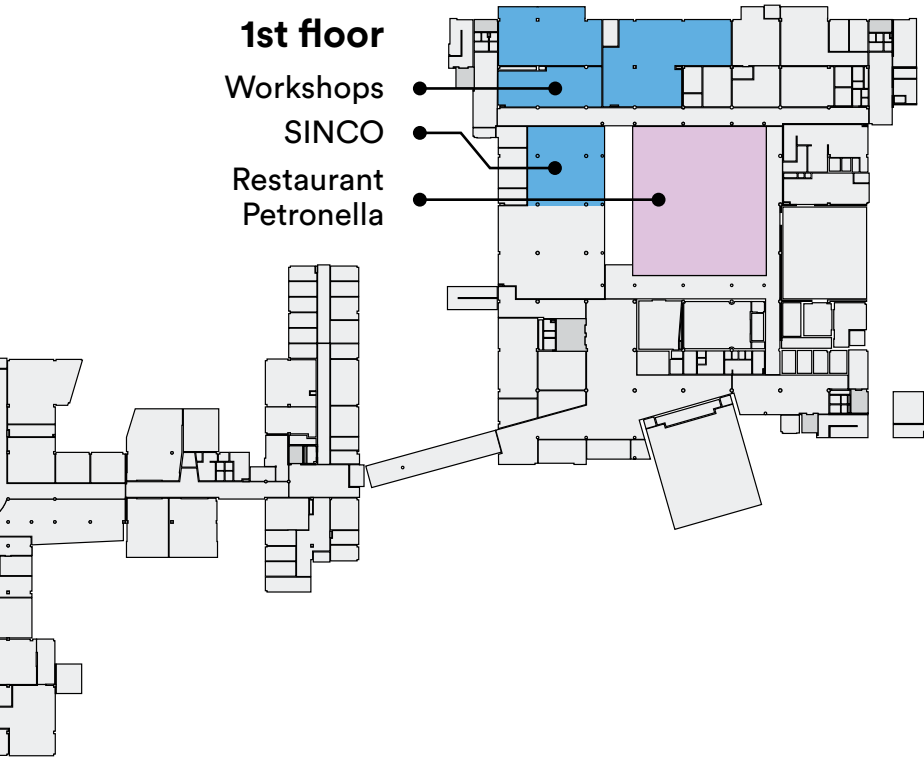

### 3rd floor

Fabric Printing  
Workshop

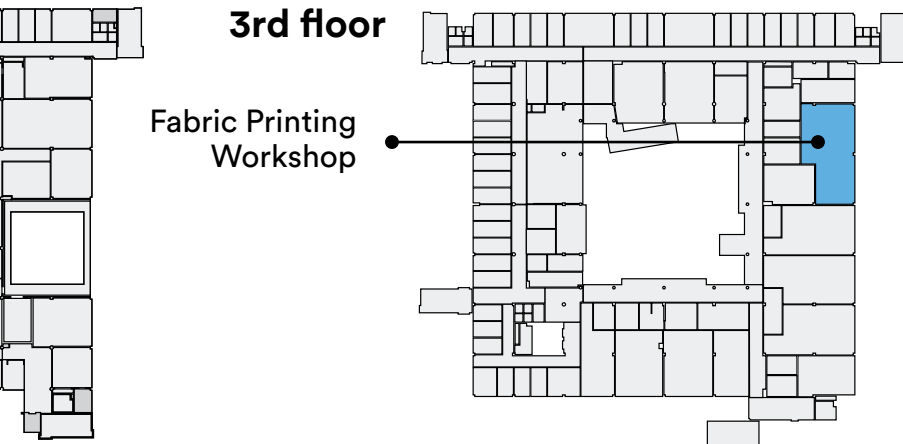

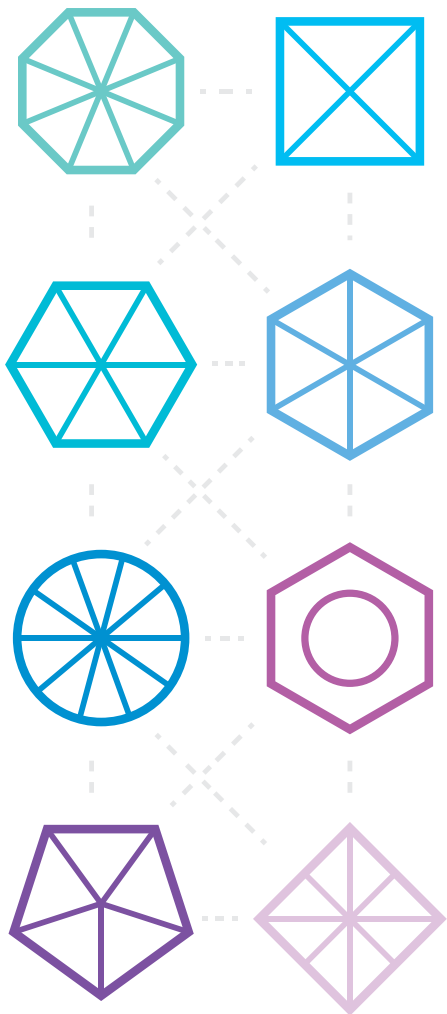

**CIRRUS**  
Network Meeting  
2016



LAPIN YLIOPISTO  
UNIVERSITY OF LAPLAND

CIRRUS